

SECTION VIEW
SCALE 1:10

NOTE:
PATTERN FACE SHALL NOT ENCR OACH INTO SLEEPER MIN. THICKNESS 't'

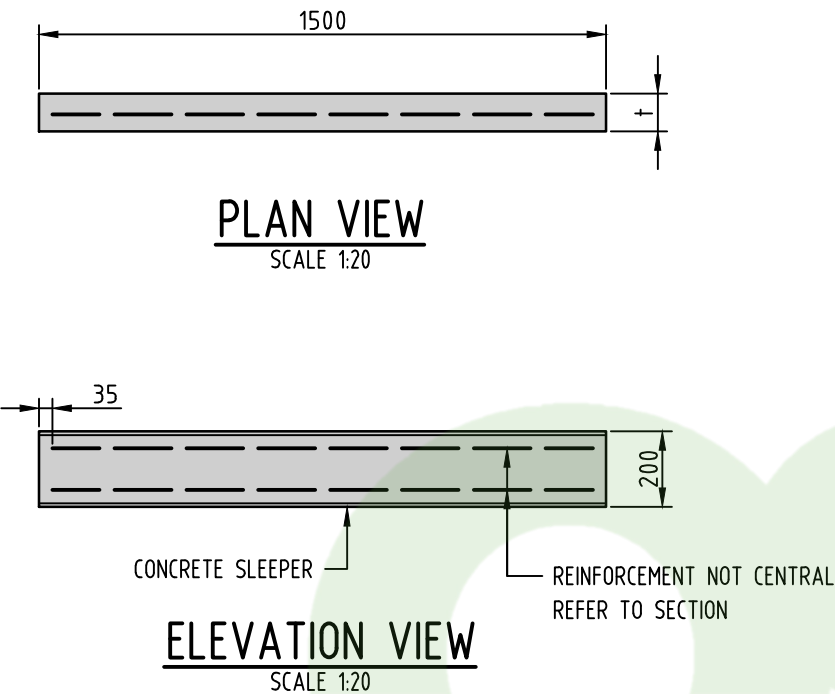

ELEVATION VIEW
SCALE 1:20

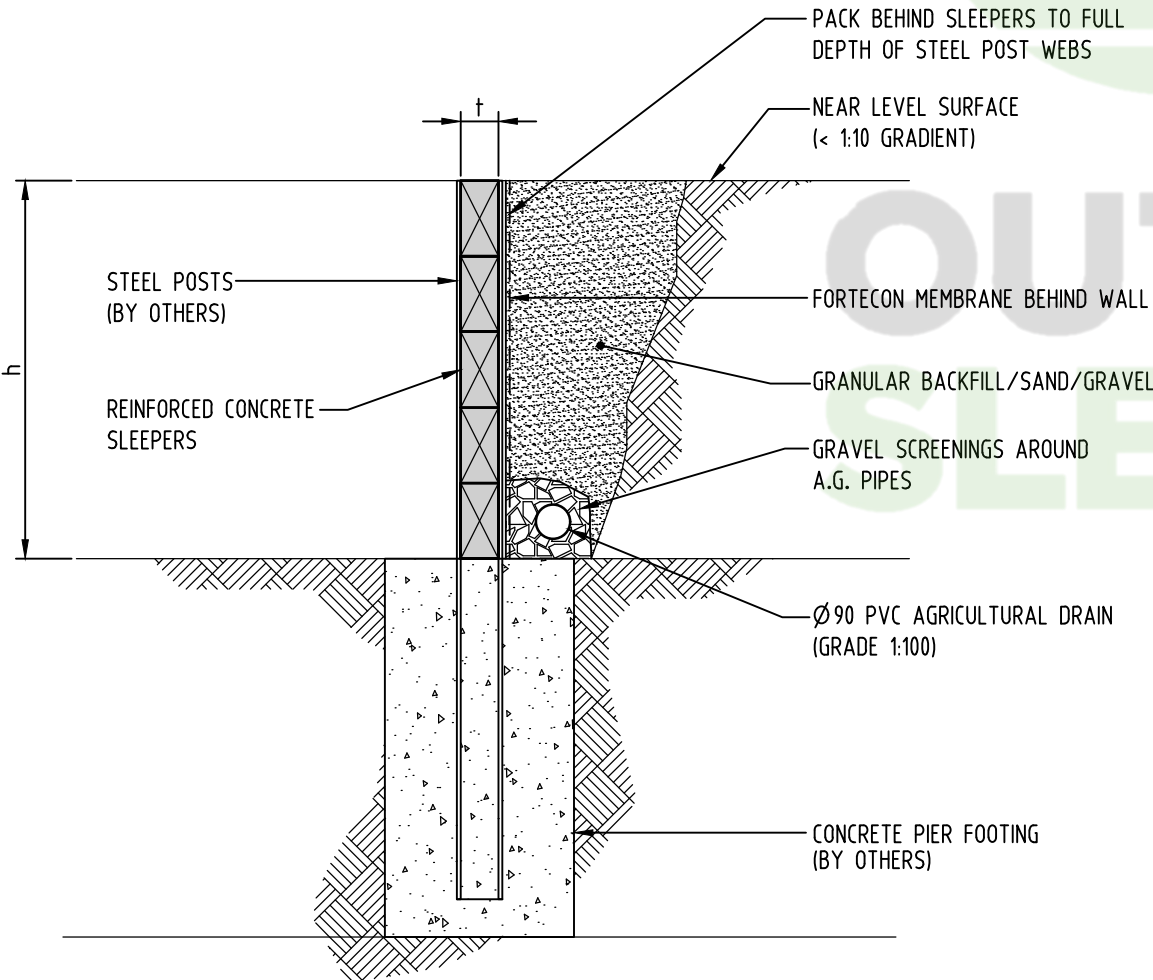

TYPICAL SECTION
SCALE 1:20

CONSTRUCTION
ISSUE

SPECIFICATIONS

- SLEEPER CONCRETE GRADE TO BE N60. RIGID FORMWORK & INTENSE CONCRETE COMPACTION IN ACCORDANCE WITH AS 3600 IS REQUIRED FOR CASTING EACH SLEEPER.
- HAND COMPACTING EQUIPMENT ONLY IS PERMITTED TO BE USED ADJACENT SLEEPERS (WITHIN DISTANCE = 0.75H)
- THESE SLEEPER SPECIFICATIONS ARE ONLY SUITABLE FOR USE WITH RETAINING WALLS WHICH SATISFY THE FOLLOWING CONDITIONS/LIMITATIONS.
 - THE WALL IS NOT SUBJECT TO HEAVY SURCHARGE LOADS. FOR EXAMPLE, NEARBY EXISTING RETAINING WALLS, STRUCTURES OR BUILDINGS WITHIN A DISTANCE EQUAL TO TWO TIMES THE WALL HEIGHT.
 - THE FINAL SURFACE GRADIENT ABOVE THE WALL IS LESS THAN 1 VERTICAL RISE IN 10 HORIZONTAL.
 - SLEEPERS ARE HANDLED WITH DUE CARE DURING TRANSPORTATION & ERECTION.
- SLEEPER MINIMUM END BEARING LENGTH SHALL NOT BE LESS THAN 25mm EACH END.
- FOR DETERMINATION OF THE APPROPRIATE SLEEPER TYPE, THE HEIGHT IS MEASURED FROM THE TOP OF THE WALL TO THE APPLICABLE SLEEPER. A WALL FACE CROSS SECTION MAY CONSIST OF VARIOUS SLEEPER TYPES.

ASSUMED SOIL
PROPERTIES

γ_s = 18kN/m³
 ϕ = 30°

ASSUMED MAX.
SURCHARGE

Q = 5kPa

SLEEPER LENGTH (l) = 1500mm

WALL TYPE	WALL HEIGHT (h)	THICKNESS t (mm)	REINFORCEMENT
1.5m STD	≤ 2.6m	75	2-N10
1.5m HEAVY DUTY	≤ 4.0m	100	2-N10

REV.	DATE	DESCRIPTION	DRAFT	ENG.	CHK.
0	24.09.21	CONSTRUCTION ISSUE	AT	CL	CL
1	13.09.23	CONSTRUCTION ISSUE	AD	HB	CL
2	15.09.23	CONSTRUCTION ISSUE	AD	HB	CL

WGA
WALLROBE GILBERT
AZTEC
60 Wyatt Street, Adelaide
South Australia 5000
Telephone 08 8223 7433
Email adelaide@wga.com.au

CONCRETE SLEEPERS
OUTBACK SLEEPERS AUSTRALIA P/L

1500mm LONG SLEEPER

A3
Job Number
DRAWING NUMBER
WAD150933 S06 2